

# Proximity Probe Mounting Hardware – Blocks – Standard

## For 8 mm Size Probes

### DM902-1A

Aluminum Proximity Probe Mount, clamping version, with clearance hole for 3/8-24 Threaded Probe case

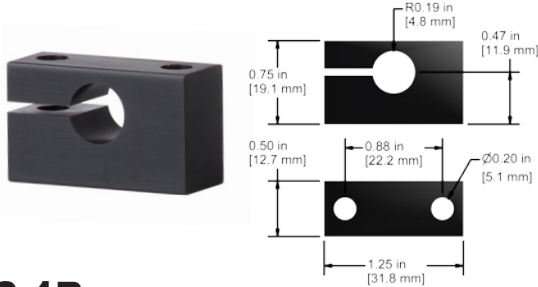

### DM902-2A

Aluminum Proximity Probe Mount, non-clamping version, with 3/8-24 Threaded Hole

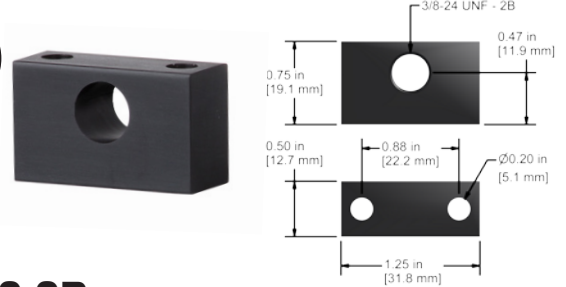

### DM902-1B

Phenolic Proximity Probe Mount, clamping version, with clearance hole for 3/8-24 Threaded Probe case

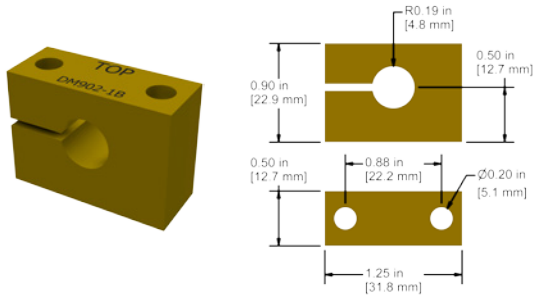

### DM902-2B

Phenolic Proximity Probe Mount, non-clamping version, with 3/8-24 Threaded Hole

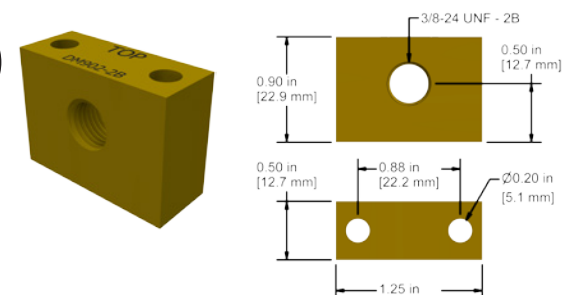

## For FFv and 5 mm Size Probes

### DM922-1A

Aluminum Proximity Probe Mount, clamping version, with clearance hole for 1/4-28 Threaded Probe case

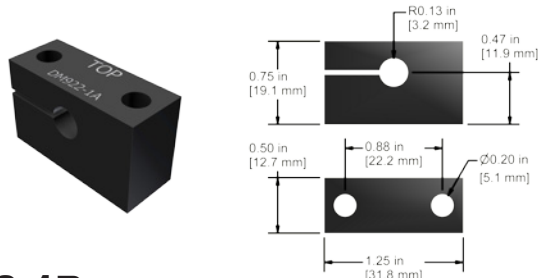

### DM922-2A

Aluminum Proximity Probe Mount, non-clamping version, with 1/4-28 Threaded Hole

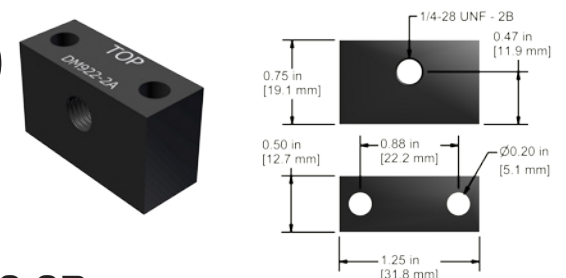

### DM922-1B

Phenolic Proximity Probe Mount, clamping version, with clearance hole for 1/4-28 Threaded Probe case

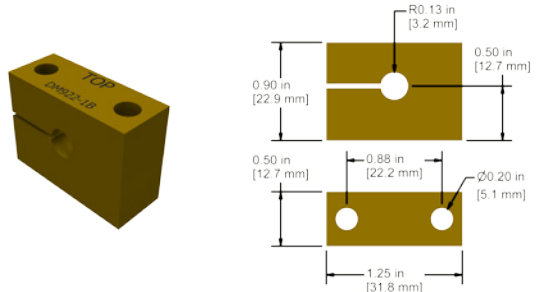

### DM922-2B

Phenolic Proximity Probe Mount, non-clamping version, with 1/4-28 Threaded Hole

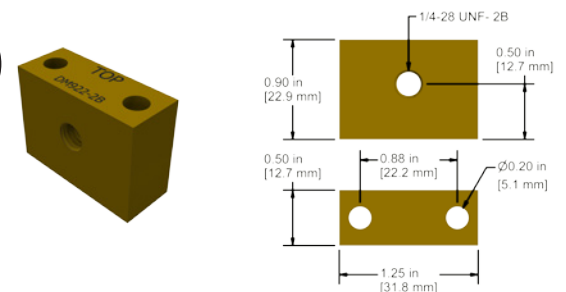

SECTION 6 - PRO LINE  
Proximity Probe Mounting Hardware

Lifetime Warranty on Materials & Workmanship

[www.ctconline.com](http://www.ctconline.com)

